



## Grazing Tender Bid Form

Bids must be submitted before the closing date of Midnight March 31, 2022 to the Ducks Unlimited representative:

ATTENTION: Lyle Hauser  
Ducks Unlimited Canada  
PO Box 3232  
Wainwright, AB.  
T9W 1T2  
Phone: 780-806-9055  
E-Mail: l\_hauser@ducks.ca

**BIDDER:**

I, \_\_\_\_\_ of  
(Name, Please print)

\_\_\_\_\_  
(Mailing address)

\_\_\_\_\_  
(Town and Postal Code)

\_\_\_\_\_  
(Phone number with area code)

\_\_\_\_\_  
(E-mail Address)

Project: Kochan, R. & Golledge, J. located at: SW -- 1 -- 49 -- 8 -- W4M

Grazing Period: 2300 AUDays Per Year--July 15 – Oct 15 - (92 days).

On an estimated 125 acres. See attached Sketch Plan.

One Animal Unit Day (AUD) = Pasture for a 1000lb animal or mature cow with suckling calf for one day.

**The amount of my BID is \$\_\_\_\_\_ per Animal Unit Day, plus applicable taxes.**

I understand and agree that the attached GENERAL CONDITIONS and SPECIAL PROVISIONS, if any, form a part of this tender bid and I am prepared to enter into a Grazing Management Agreement if I am the successful bidder.

\_\_\_\_\_  
Bidder's Signature

Date: \_\_\_\_\_

\_\_\_\_\_  
Print Name



## **General Conditions – Grazing**

- 1. The term of this agreement will be for Graze in 2022 & 2024, 2023 year On Golledge Project year(s) commencing July 15, 2022 and expiring Oct 15, 2024.**
2. Only proper Ducks Unlimited Canada (DUC) Tender forms will be accepted and the specified closing times for bids are strictly enforced.
3. The highest, or any bid, may not be accepted. Processing bids and the subsequent awarding of the contract will take approximately one week.
4. The bidder is responsible for viewing the land prior to bidding; foot access only is permitted when viewing the property.
5. Before placing any livestock on the property the successful bidder must provide full payment of the bid amount to DUC. All payments are to be given to DUC as per the invoice and are to be made in the form of a cheque made payable to “Ducks Unlimited Canada”.
6. The bidder is responsible for fence maintenance and water supply if such supply does not exist on the property.
7. Any acreage numbers listed or shown in this tender process are approximate.
8. Schedules: Grazing must not start before the Earliest Start Date specified and all livestock must then be removed from the property by the Latest Removal Date as specified. The DUC representative must approve any deviation from the removal date. If livestock are not removed before the specified Latest Removal Date, DUC may seek damages and will pursue legal action as necessary to have the cattle removed.
9. The number of grazing days or units tendered is an approximation. If either party considers the forage stand to be deteriorating below acceptable levels the grazing period may be terminated. In such cases, payments made to DUC will be refunded to the bidder, prorated by comparing the actual days (or units) used to the original bid assumption of the number of days (or units) of grazing that would be available.
10. The bidder shall assume full responsibility for safety in accordance with all the applicable laws, regulations and generally accepted practices, including safety of all persons and property.
11. The bidder shall ensure that they operate with due consideration for the condition of the property and not enter or run equipment if field conditions are such that damage to the land will occur (for example, trucking or other equipment under wet or soft field conditions).
12. DUC does not guarantee the land to be free of noxious weeds or poisonous plants and is not responsible for any damages caused by insects or other wildlife that may occur to the forage stand. If the bidder deems it necessary to apply pesticide, at his/her cost, the DUC representative must approve the application.





Ducks Unlimited Canada

## **Kochan, R. Project-- SW 1-49-8 W4M—County of Minburn**



Grazing July 15<sup>th</sup> to October 15th, 2022 & 2024 (Golledge Project in 2023)  
2300 AUDays, 160 acre pasture, 4 wire fence including one 20 acre paddock on west side—  
Good access, fences, water & dug-out





Ducks Unlimited Canada

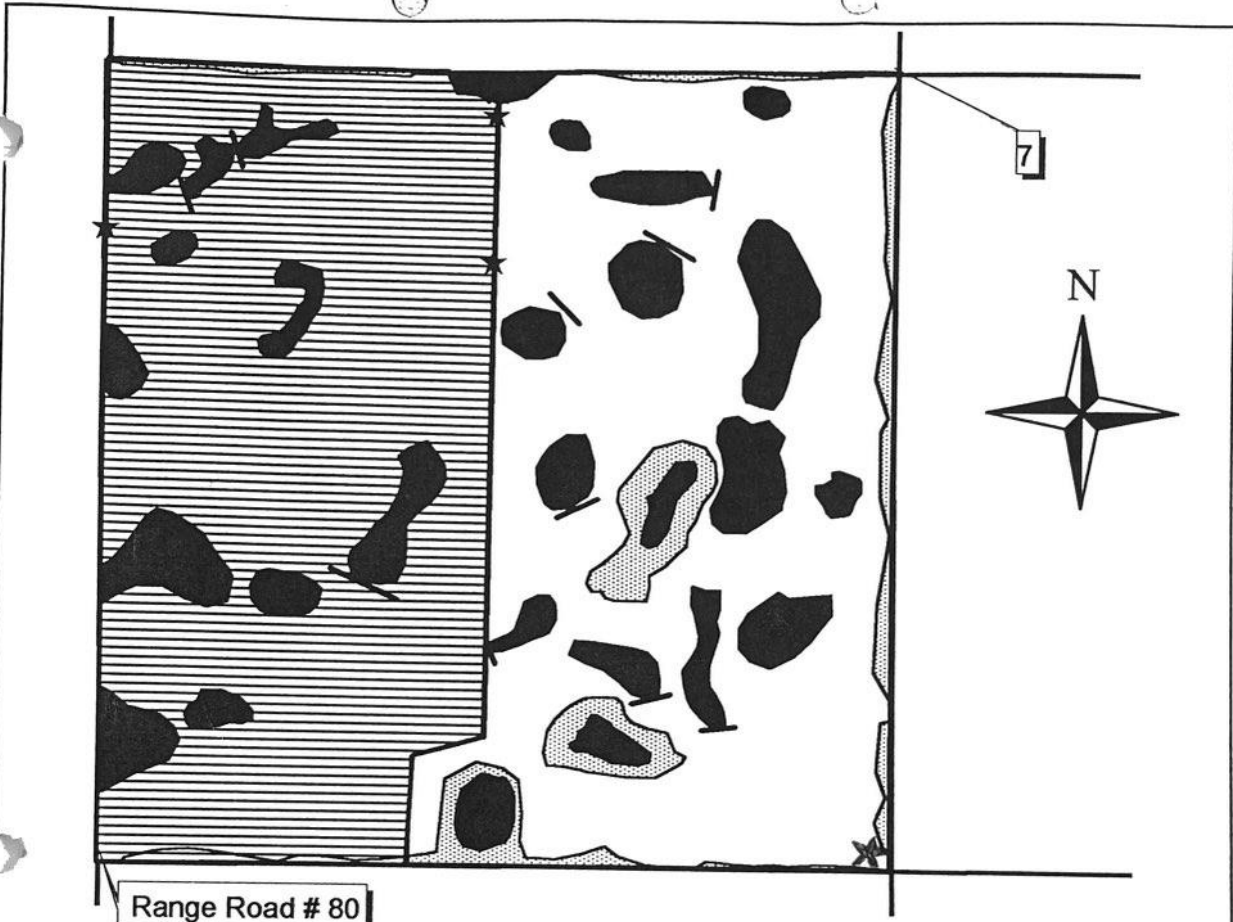

Range Road # 80

Legend	Segment Definition	Acres
Wetlands	2200 Small Wetland Complex	13.8
	2231 Small Wetland - Ditch Plug	8.9
Deferred Tame Pature	9911 Grazing on DUC Land - LUEP	65.1
Early Season Pasture	9911 Grazing on DUC Land - LUEP	65.5
Bush	9911 Grazing on DUC Land - LUEP	6.7
Fence line		
Gate		
Water site		
Ditch plug		

Golledge Project  
P-374-1429

<p>Ducks Unlimited Canada GIS SKETCH PLAN</p>	Description Golledge, J. Project	Landscape Viking Moraine	THIS SKETCH PLAN HAS BEEN PREPARED FROM AIR PHOTO INTERPRETATION
	Land Parcel: SW 7 - 49 - 7W4		Date Drawn: November 2 By: RJS
	NTS Map Sheet: 73E	Scale: 1:6585	File: c:\gisdata\gisproj\sketch\vick\golledge.apr
	Photo No.: Vermillion River - Digital	Photo Date: June 1, 1999	Page: 1 Checked By: SS